

Dual Dry Remote Display Upgrade

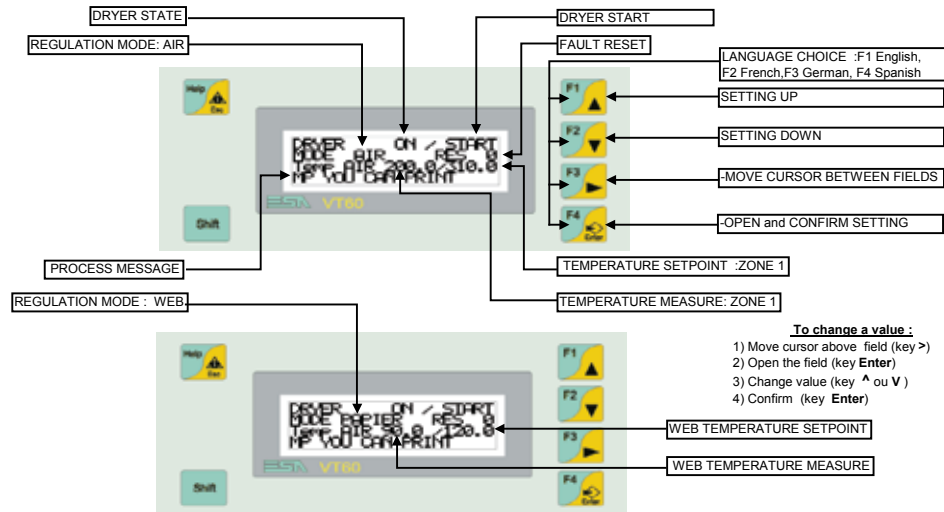

Safety Panel operator VT60 connect on PLC (MPI gate) with specially cable
It put up process messages
You can start dryer , change regulation mode and temperature setpoint, and reset faults
4 languages available : English, French, German, Spanish.

MEGTEC Reference VT60: 00414409
MEGTEC Reference Cable: ZPZ03657

New features with upgrade:

- ➔ Remote dryer start
- ➔ Change from air to web mode
- ➔ Set temperature
- ➔ Reset faults

The upgrade kit comprises:

- ➔ P/N/ 00414409: operator terminal VT60 v.2
- ➔ P/N ZPZ03657: VT60-CPU cable
- ➔ Software upgrade
- ➔ Instructions for installation

Simple Installation:

- ➔ Connect the power supply; 24V on the PLC and follow instructions enclosed

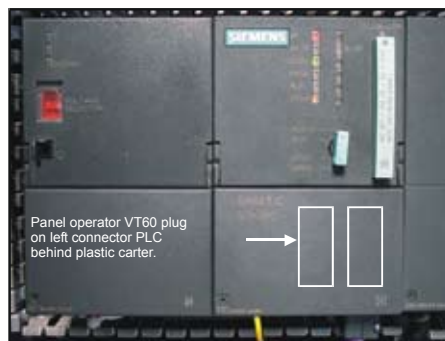

For further information, availability, please contact your nearest MEGTEC office by visiting www.megtec.com and click on parts and upgrades or email to info@megtec.com.